

eka SYSTEM | complex E FDL/FEL

Flexible Edelstahlsysteme

Doppellagig (FDL) und einlagig (FEL)

Wanddicke FDL: 2 x 0,12 mm FEL: 0,12 mm

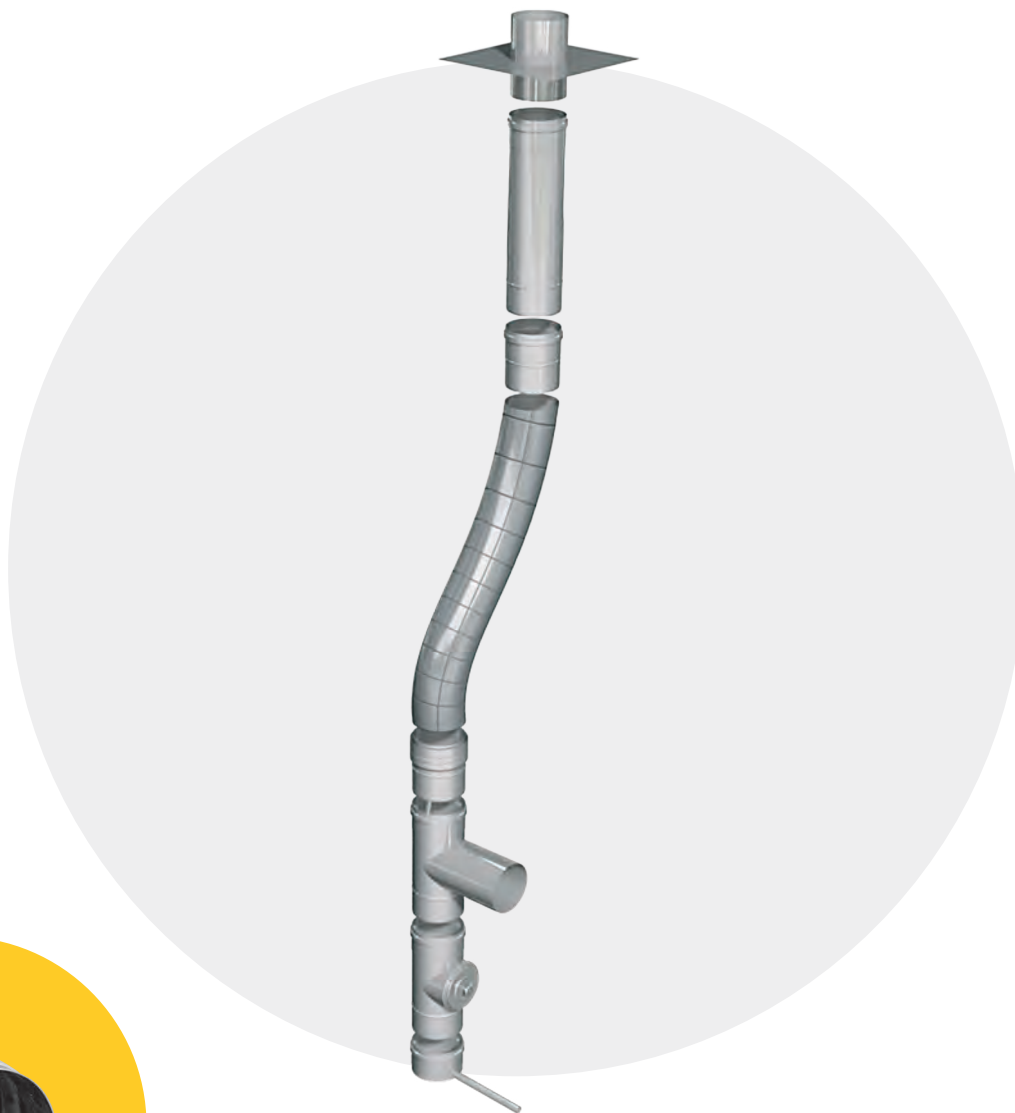

PREISLISTE 2025
TECHNISCHE DATEN

STAND NOV. 2024



eka

A Sphering Company

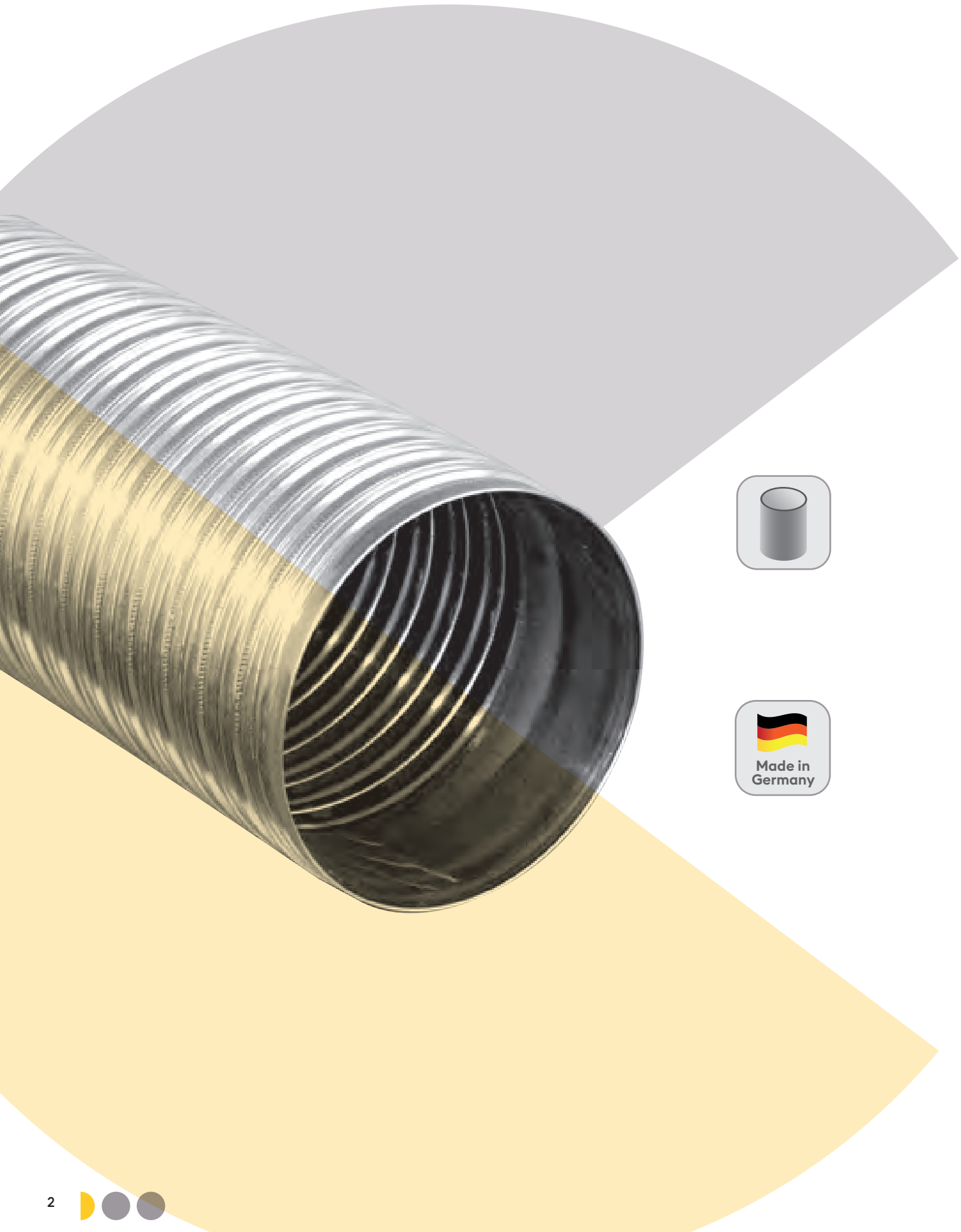

eka complex E FDL/FEL

Flexible Edelstahlsysteme

Doppellagig (FDL) und einlagig (FEL)

Wanddicke FDL: 2 x 0,12 mm FEL: 0,12 mm

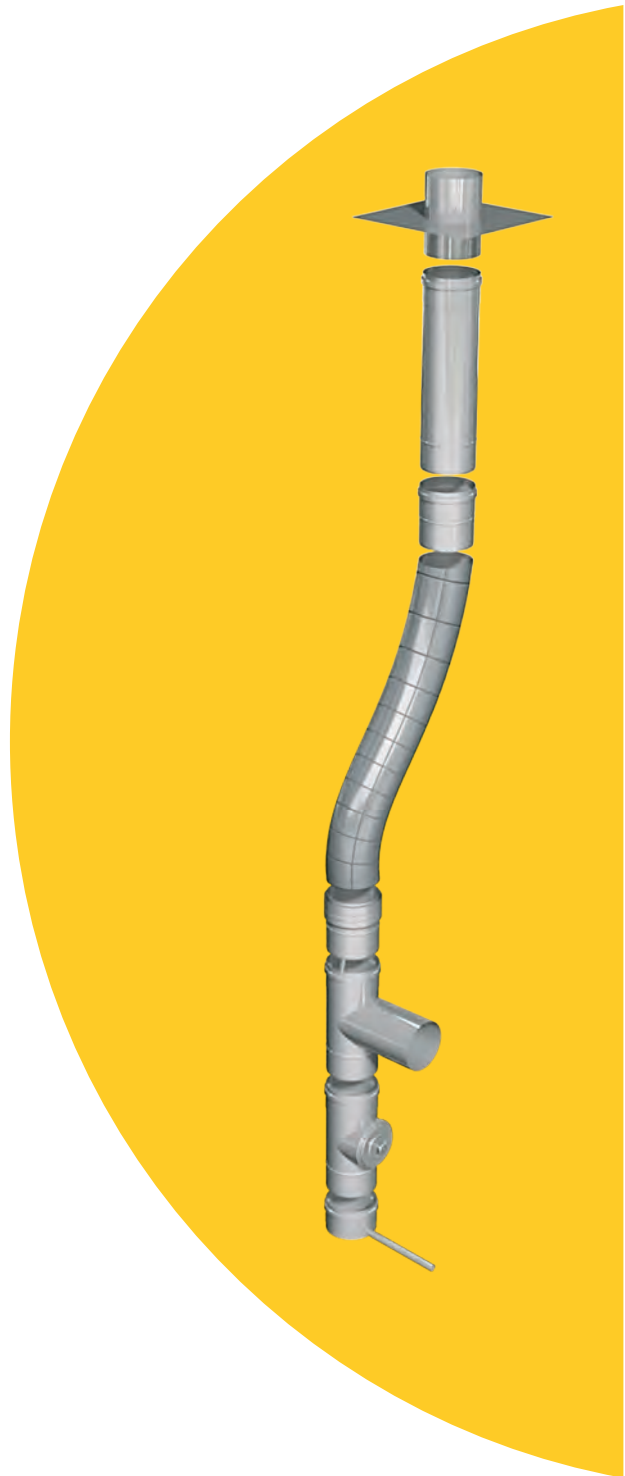

eka

A Sphering Company



Flexrohrpaket, doppellagig (Länge [m])

2400-Ø-FDL

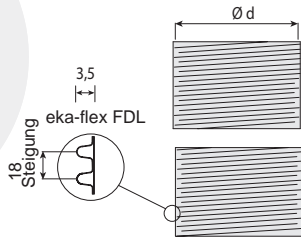
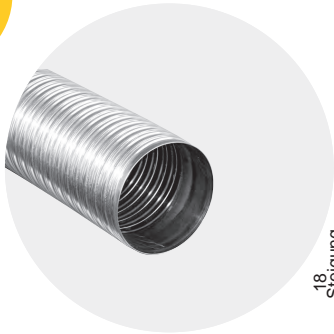



Durchmesser Ø mm	80	100	113	120	130	140	150	160	180	200
2400 Ø FDL- 7,5	464,10	475,70	505,40	521,00	537,70	572,70	607,60	680,00	782,00	822,00
2400 Ø FDL- 10	619,10	634,80	673,40	695,40	717,40	762,60	810,40	907,40	1.042,90	1.096,00
2400 Ø FDL- 12,5	774,20	792,30	841,40	869,80	897,00	953,80	1.012,00	1.133,60	1.304,10	1.369,90
2400 Ø FDL- 15	929,30	951,20	1.010,70	1.042,90	1.076,70	1.145,10	1.215,00	1.360,90	1.565,10	1.643,90
2400 Ø FDL- 20	1.239,50	1.269,30	1.348,00	1.392,00	1.435,90	1.526,30	1.620,70	1.814,50	2.087,20	2.191,90
2400 Ø FDL- 25	1.549,60	1.585,70	1.684,00	1.739,50	1.795,20	1.908,90	2.025,20	2.268,10	2.608,00	2.739,80
2400 Ø FDL- 30	1.858,50	1.902,40	2.021,40	2.085,80	2.153,30	2.290,20	2.429,90	2.721,80	3.130,10	3.287,80
Gewicht pro Meter										
	0,70	0,90	1,00	1,05	1,10	1,20	1,30	1,40	1,60	1,75

Adapter starr/flex doppellagig

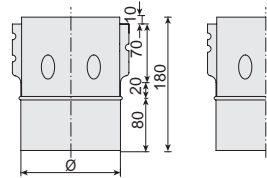
2400-Ø-FASFDL



Ø d	*Lg	€
80	0,34	35,20
100	0,42	35,20
113	0,48	35,90
120	0,51	36,90
130	0,55	38,30
140	0,59	40,80
150	0,63	43,20
160	0,69	45,60
180	0,76	51,10
200	0,84	53,50



-  Adapter rigid / flex double wall
-  Adapteur rigide flexible double couche

Adapter flex/starr doppellagig

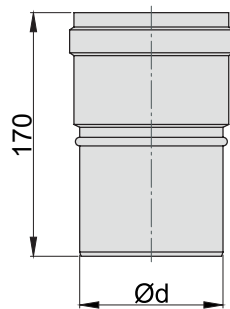
2400-Ø-FAFSDL



Ø d	*Lg	€
80	0,20	11,50
100	0,26	12,10
113	0,29	12,10
120	0,31	12,90
130	0,33	12,90
140	0,36	12,90
150	0,38	14,60
160	0,41	15,30
180	0,46	17,70
200	0,51	18,50

-  Adapter flex / rigid double wall
-  Adapteur flexible / rigide double couche

 **HINWEIS**



FAFSDL-BW für Brennwertanlagen

Adapter flex/flex doppellagig

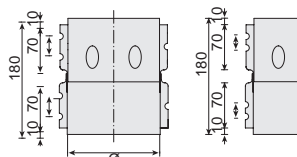
2400-Ø-FAFFDL



Ø d	*Lg	€
80	0,43	33,00
100	0,54	35,20
113	0,61	35,90
120	0,65	36,90
130	0,71	38,30
140	0,76	40,80
150	0,81	43,20
160	0,87	45,60
180	0,98	51,10
200	1,09	53,50

-  Adapter flex / flex double wall
-  Adapteur flexible / flexible double couche

*Lg=Legierungsgewicht: Lg (in kg) x Faktor Legierungszuschlag (in €/kg) = Netto-Aufpreis Legierungszuschlag

Flexrohrpaket, einlagig - (Länge [m])

2400-Ø-FEL

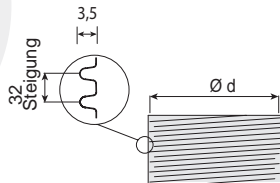



Durchmesser Ø mm	80	100	113	120	130	140	150	160	180	200
2400 Ø FEL- 7,5	265,10	271,60	283,20	299,90	318,10	345,20	385,30	408,40	447,30	499,00
2400 Ø FEL- 10	354,20	362,10	377,50	400,80	424,00	461,50	514,50	544,10	597,10	664,40
2400 Ø FEL- 12,5	443,40	452,50	471,80	501,50	530,00	576,50	642,40	681,10	747,10	831,10
2400 Ø FEL- 15	531,30	543,00	566,20	601,00	637,20	691,60	771,70	816,80	895,70	997,70
2400 Ø FEL- 20	709,70	723,90	756,20	802,60	849,20	922,80	1.028,90	1.089,50	1.195,50	1.329,90
2400 Ø FEL- 25	886,60	904,80	944,90	1.002,90	1.061,10	1.154,10	1.285,90	1.362,20	1.494,00	1.663,40
2400 Ø FEL- 30	1.062,50	1.085,90	1.132,40	1.202,00	1.274,40	1.383,20	1.543,30	1.633,60	1.791,30	1.995,40
Gewicht pro Meter										
	0,45	0,55	0,60	0,65	0,70	0,75	0,80	0,85	0,95	1,05

Adapter starr/flex einlagig

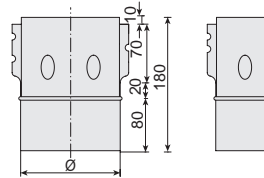
2400-Ø-FASF



Ø d	*Lg	€
80	0,34	33,00
100	0,42	35,20
113	0,48	35,90
120	0,51	36,90
130	0,55	38,30
140	0,59	40,80
150	0,63	43,20
160	0,69	45,60
180	0,76	51,10
200	0,84	53,50



-  Adapter rigid/flex single wall
-  Adapteur rigide / flexible mono couche

Adapter flex/starr einlagig

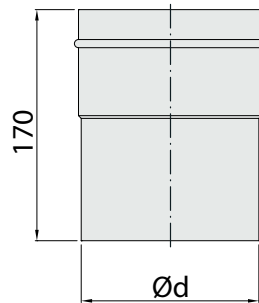
2400-Ø-FAFS



Ø d	*Lg	€
80	0,20	11,50
100	0,26	12,10
113	0,29	12,10
120	0,31	12,90
130	0,33	12,90
140	0,36	12,90
150	0,38	14,60
160	0,41	15,30
180	0,46	17,70
200	0,51	18,50



-  Adapter flex / rigid single wall
-  Adapteur flexible / rigide mono couche

Adapter flex/flex einlagig

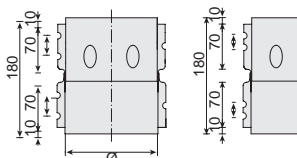
2400-Ø-FAFF



Ø d	*Lg	€
80	0,43	33,00
100	0,54	35,20
113	0,61	35,90
120	0,65	36,90
130	0,71	38,30
140	0,76	40,80
150	0,81	43,20
160	0,87	45,60
180	0,98	51,10
200	1,09	53,50

-  Adapter flex / flex single wall
-  Adapteur flexible / flexible mono couche



*Lg=Legierungsgewicht: Lg (in kg) x Faktor Legierungszuschlag (in €/kg) = Netto-Aufpreis Legierungszuschlag

Abstandshalter doppellagig/einlagig

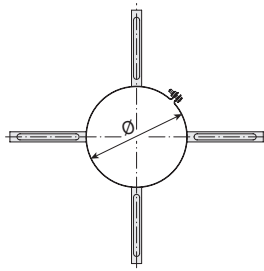
2400-Ø-FAH



Ø d	*Lg	€
80	-	24,00
100	-	24,00
113	-	24,00
120	-	24,00
130	-	24,00
140	-	25,80
150	-	26,40
160	-	26,40
180	-	26,40
200	-	28,30



-  Distancer for flex double/single
-  Distancieur double mono

Montagesonde

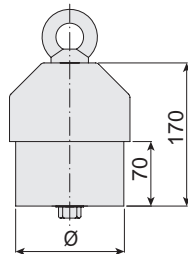
2400-Ø-FMS



Ø d	*Lg	€
80	-	64,70
100	-	68,40
113	-	70,00
120	-	71,40
130	-	73,00
140	-	74,40
150	-	76,00
160	-	79,80
180	-	83,50
200	-	87,40

-  Installation tool for flex
-  Outil de montage

Schrumpfschlauch

1000-Ø-FDLSST

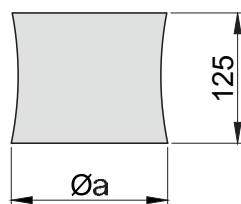

Ø d	Ø a	*Lg	€
80	130	-	25,80
100	130	-	25,80
113	130	-	25,80
120	160	-	28,80
130	160	-	28,80
140	160	-	28,80
150	180	-	33,90
160	180	-	33,90
180	265	-	50,40
200	265	-	50,40

-  Installation tool for flex, max. 100°C
-  Toulage pour montage, max. 100°C

 **HINWEIS**

Für Brennwertanlagen max. 100°C

Systembauteile von complex E verwenden (siehe vorheriges Kapitel Complex E)

*Lg=Legierungsgewicht: Lg (in kg) x Faktor Legierungszuschlag (in €/kg) = Netto-Aufpreis Legierungszuschlag



eka-edelstahlkamine GmbH
Robert-Bosch-Straße 4
D-95369 Untersteinach
tel.: (+49) 9225 981-01
fax: (+49) 9225 981-11
info@eka-edelstahlkamine.de

eka-edelstahlkamine.de



sphering-group.com



Flue & Air Care
Since 1919